

Apollo PE 3419 Order Form



Select Package:

Select One

Standard Package (Stop here. Order form complete)	<ul style="list-style-type: none"> • Single Inlet Ground Base • 3505 Storage Bracket • Wireless Hand Held • CAN 4 Toggle Switch Box (Right/Left, Up/Down, Fog/Stream, Oscillation) 	<ul style="list-style-type: none"> • Truck Mount Flange • Truck Power Harness • 5177 Akromatic 1250 Nozzle
Custom Package (Continue on following pages to complete order form)	<ul style="list-style-type: none"> • Custom configurations may have longer lead times. Please contact customer care for pricing and availability. 	

Select Ground Base/Flange:

Select Any

	Dual Inlet Ground Base (2-2.5 NH unless otherwise specified)
	Single Inlet Ground Base (Specify connection type & size)
	No Base
	Truck Mount Flange

Select Outlet:

Select One

	NH
	Other, Specify _____

Select Nozzle: (specify thread if other than NH)

Select All That Apply

	No Nozzle
	5177 Akromatic 1250gpm (4800lpm)
	1578 Sabermaster 1250gpm(4800lpm) fog with 2" smooth bore
	4040 Akro-Chem 250-1250gpm (950-4800lpm) water/foam & dry chemical nozzle
	3626 1000gpm (3800lpm) Master Stream Foam Tube
	3626 800gpm (3030lpm) Master Stream Foam Tube
	2498 Triple Stack Tip (Requires 3488 or 3485 shaper)
	2499 Quad Stack Tip Set (requires 3488 or 3485 shaper)
	3485 2.5" x 2.5" mini shaper, 4" long (3482)
	3488 2.5" x 2.5" standard shaper 11.5" long (3482)
	No Shaper

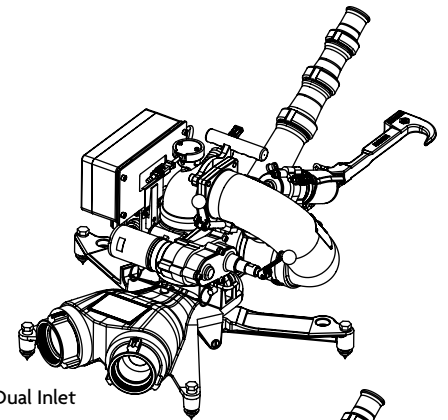

Dual Inlet

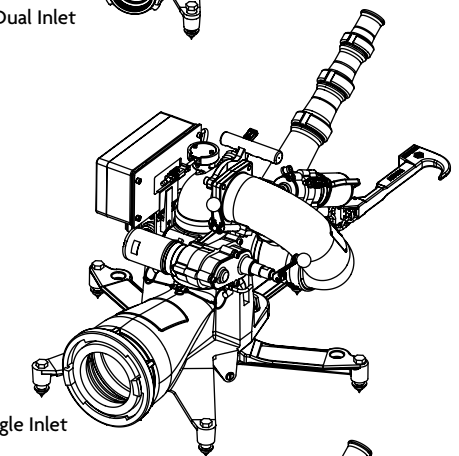

Single Inlet

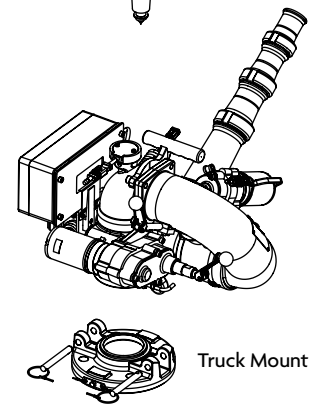

Truck Mount Flange

Select Control Options

Select Any

60412002		CAN Tether with Mini Joystick Stow/Deploy, Osc, Fog/Stream, & Valve" with Panel Connector	
60470002		Handheld Wireless Controller Left/Right, Up/Down, Fog/Stream, Stow/Deploy, Oscillate & Valve	
60470010		Battery Charger	

Select Any

60410023		CAN 3 Toggle Up/Down, Right/Left, & Fog/Stream	
60410034		CAN 4 Toggle Oscillation, Up/Down, Right/Left, & Fog/Stream	

Apollo PE 3419

Order Form



Akron Brass offers pre-engineered cable assemblies to quicken the installation process. **These are optional items.** Refer to the example system diagram below to identify which cable assemblies you require, then indicate the quantity next to the corresponding part number in the list below.

Option #1: Only available if you are using 1 controller other than a handheld wireless.

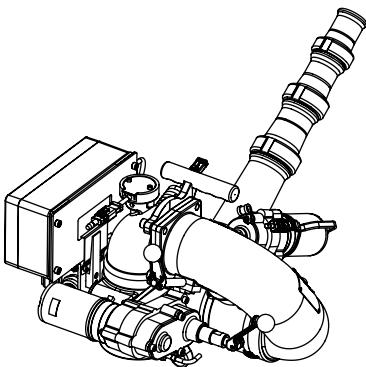

Internally Terminated Control Cable

For use with
Toggle Switch Box or
Joystick or Tether
(Only One)

Select One

	20 Foot	721565
	30 Foot	721634

Option #2: When using more than 1 controller other than a handheld wireless.

CAN Network Wiring Assemblies

	Quantity	Part #	Description
①	1	721589	Monitor interface harness. Provides connection between onboard controller and CAN network. One needed per system. 3ft. (1m)
②		721579	CAN device stub harness with power and ground leads 3ft. (1m)
③		758306	CAN network Tee. Provides connection between device stubs and network extension cables.
④	2	742205	CAN network terminator plugs. Two required per system (one at each end of network)
⑤		Part#	CAN network extension cables used between device tees.
		721572	3ft. (1m)
		721573	5ft. (1.5m)
		721574	10ft. (3m)
		721570	20ft. (6m)
		721575	40ft. (12m)

