

THIS DRAWING AND ALL INFORMATION CONTAINED HEREIN IS THE PROPERTY OF WELDON TECHNOLOGIES, INC. AND MAY NOT BE COPIED, REPRODUCED, OR DEVULGED TO UNAUTHORIZED PERSONS WITHOUT THE EXPRESS WRITTEN CONSENT OF WELDON TECHNOLOGIES, INC. AS IT IS BEING PROVIDED SOLELY FOR THE CONVENIENCE OF THE USER AND SHALL BE RETURNED TO WELDON TECHNOLOGIES, INC UPON REQUEST.

REVISIONS				
REV.	ECN	DESCRIPTION	DATE	BY / APVD
A	R0694	DOCUMENTATION RELEASE	7/5/06	TS / ST

LENS SCREW  
TIGHTENING TORQUE  
8-12 in/lbs

CLEARANCE FOR  
#10 SCREW (MAX.)  
(4 PLCS.)  
INSTALLATION TORQUE  
18 in/lbs (MAX.)

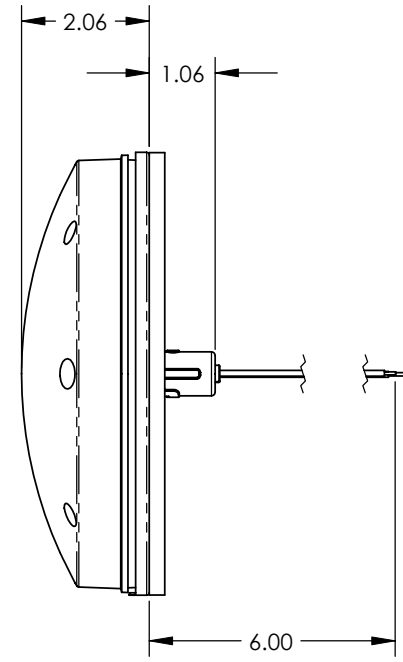
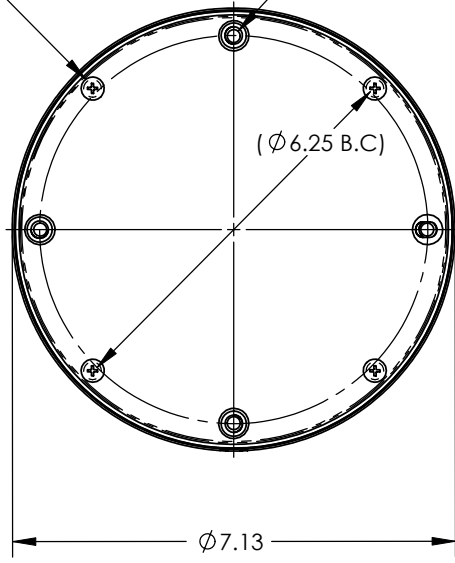

Service Part Number	Description	10-10-1120-10 Qty.	10-10-1120-20 Qty.
1003-0000-10	Lens, Acrylic, Red	1	-
1003-0000-20	Lens, Acrylic, Amber	-	1
1014-0000-00	Gasket, Lens	1	1
1015-0000-00	Gasket, Mounting	1	1
9018-0020-00	Bulb, Miniature, #1157, 32cp/3cp	1	1
9028-0006-00	Screw, Lens, 8-32 x 7/16 PPHMS, TT	4	4

UNLESS OTHERWISE SPECIFIED DIMENSIONS ARE IN INCHES TOLERANCES ARE: X.XXX - $\pm$ 0.005 X.XX - $\pm$ 0.020 X.X - $\pm$ 0.050 ANGLES - $\pm$ 0.5°	CAD GENERATED DRAWING. DO NOT MANUALLY UPDATE		<b>WELDON TECHNOLOGIES, INC.</b>  CUSTOMER DRAWING 7" ROUND STOP/TAIL, PARK/TURN LAMP	
	APPROVALS	DATE		
	DRAWN	TS	7/5/06	
	CHECKED	ST	7/5/06	
MATERIAL	QUAL ENG		SIZE	PART NO.
FINISH	MFG ENG		B	C1010-1120-00
DO NOT SCALE DRAWING	PROJ. NO.		SCALE:	1:1
				REV. A
				WELDON COMPUTER GRAPHICS SHEET 1 OF 1