



## **9343/9345 NAVIGATOR 3.0 ADAPTER PLATE (LARGE AND SMALL) INSTALLATION INSTRUCTIONS FOR RETROFIT/UPGRADING FROM PREVIOUS NAVIGATOR CONTROLLERS**

These instructions provide recommended tools and steps to retrofit previous Navigator controllers to the 9343/9345 Navigator 3.0 version using the included mounting plates and hardware referenced in these instructions. Instructions cover both large mounting plate option and small mounting plate option.

### Tools required

- Drill
- Drill bit: ¼"
- Philips head screw driver
- Wrench: 3/8" opening
- Hole saw or similar tool to cut through panel as needed.
- Method for marking

### Included in this kit

- Mounting Plate-Large Qty (1)
- Mounting Plate-Small Qty (1)
- 10-24 Hex nut with nylon insert Qty (4)
- 10-24 X ¾" Philips Pan Head Screw Qty (4) (for large plate)
- 10-24 x ¾" Phillips Flat Head Screw Qty (4) (for small plate)
- 129003 Instruction sheet

### Large mounting plate instructions

1. Confirm there is suitable clearance behind the controller prior to locating and installing the mounting plate (FIGURE 1).
2. Using the dimensions from the mounting plate, layout and drill the four holes for the mounting screws in each corner (FIGURE 2).
3. Provide a larger hole in the existing pump panel, a minimum of 2-5/8", for clearance around lock nut on the back of the 9343/9345 Navigator 3.0 controller.
4. Make harness connections on the back side of the controller.
5. Mount the plate and controller to the panel using the supplied hardware or a suitable substitute for the application.

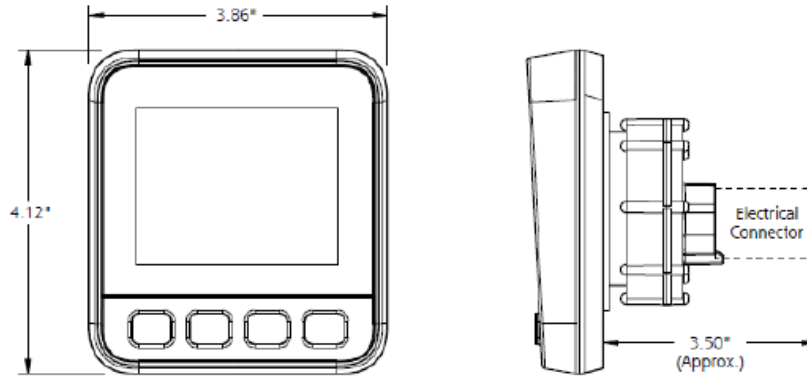

**(FIGURE 1) REQUIRED CLEARANCE BEHIND TRUCK PANEL**

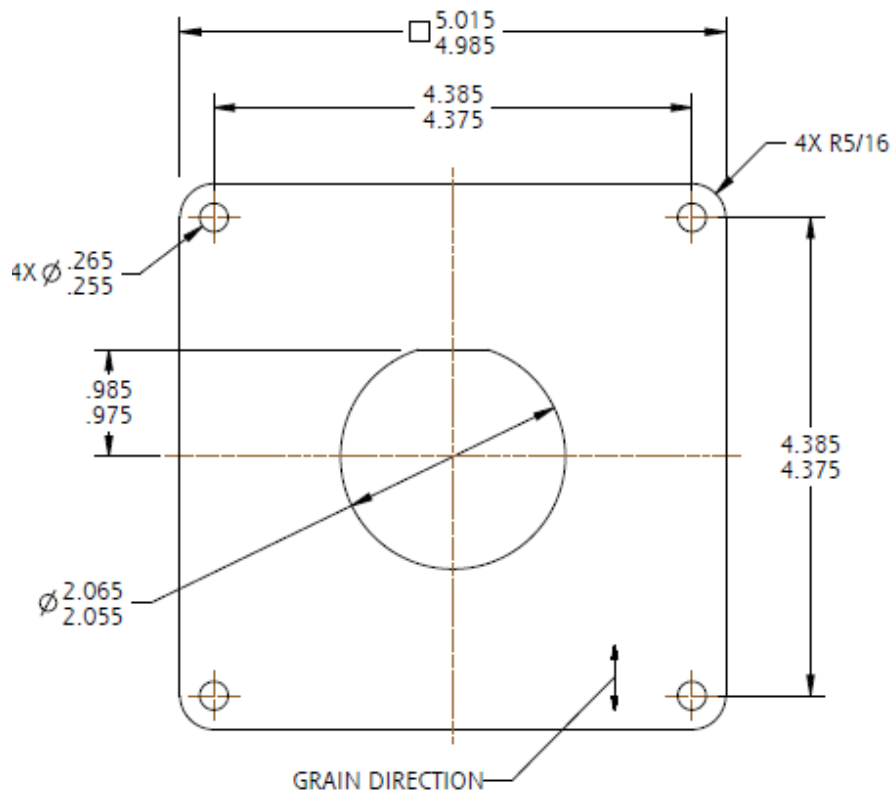

**(FIGURE 2) LARGE MOUNTING PLATE DIMENSIONS**

### Small mounting plate instructions

1. Confirm there is suitable clearance behind the controller prior to locating and installing the mounting plate (FIGURE 1).
2. The small mounting plate shown will adapt to the current bolt pattern of the 9313/9315 and 9333/9335 Navigator controllers that are being replaced (FIGURE 3).
3. If this is a new installation then use the dimensions from the mounting plate shown (Figure 3).
4. Provide a larger hole in the existing pump panel, a minimum of 2-5/8", for clearance around the lock nut on the back of the 9343/9345 Navigator 3.0 controller.

5. Make harness connections on the back side of the controller.
6. Mount the plate and controller to the panel using the supplied hardware or a suitable substitute for the application.

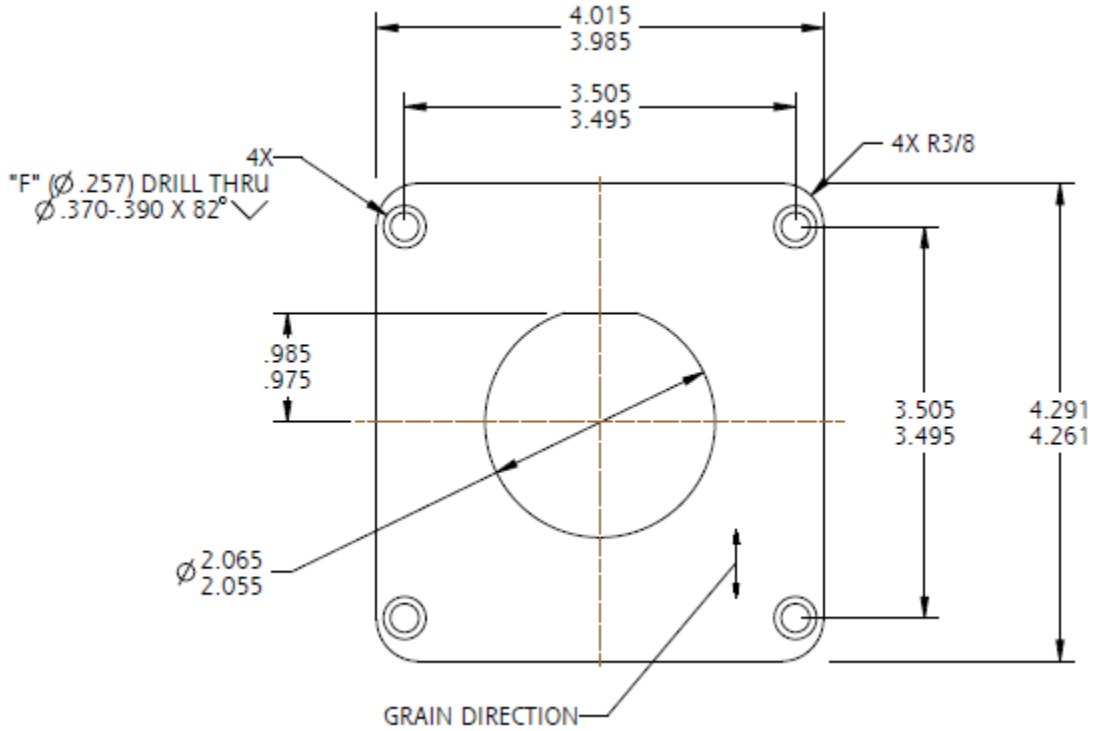

**(FIGURE 3) SMALL MOUNTING PLATE DIMENSIONS**



PHONE: 330.264.5678 or 800.228.1161 | FAX: 330.264.2944 or 800.531.7335 | akronbrass.com

revised:  
04/18

**Tested... Proven... Trusted.**

ISO 9001 REGISTERED  
COMPANY

WARRANTY AND DISCLAIMER: We warrant Akron Brass products for a period of five (5) years after purchase against defects in materials or workmanship. Akron Brass will repair or replace product which fails to satisfy this warranty. Repair or replacement shall be at the discretion of Akron Brass. Products must be promptly returned to Akron Brass for warranty service.

We will not be responsible for: wear and tear; any improper installation, use, maintenance or storage; negligence of the owner or user; repair or modification after delivery; damage; failure to follow our instructions or recommendations; or anything else beyond our control. WE MAKE NO WARRANTIES, EXPRESS OR IMPLIED, OTHER THAN THOSE INCLUDED IN THIS WARRANTY STATEMENT, AND WE DISCLAIM ANY IMPLIED WARRANTY OF MERCHANTABILITY OR FITNESS FOR ANY PARTICULAR PURPOSE. Further, we will not be responsible for any consequential, incidental or indirect damages (including, but not limited to, any loss of profits) from any cause whatsoever. No person has authority to change this warranty.

© Akron Brass Company. 2018 All rights reserved. No portion of this can be reproduced without the express written consent of Akron Brass Company