

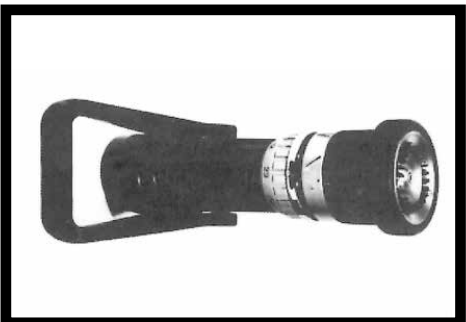

**The 9115 Kit can be used to repair the following products:**



1701, 1701P



1702, 1702P

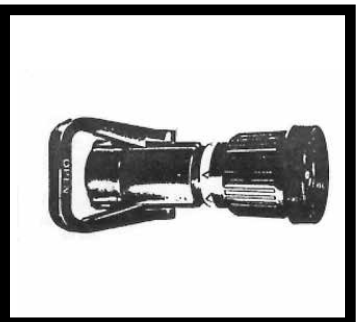

4612



4613



**Style 9115  
Field Service Kit  
for:**

- 1701P 1" Turbojet® (Pyrolite®)
- 1702P 1" Turbojet with Pistol Grip (Pyrolite)
- 1701 1" Turbojet (Chrome)
- 1702 1" Turbojet with Pistol Grip (Chrome)
- 4612 1" Marauder®
- 4613 1" Marauder with Pistol Grip

\* REGISTERED TRADEMARK



**Tested... Proven... Trusted.**

ISO 9001 REGISTERED COMPANY

PHONE: 330.264.5678 or 800.228.1161 | FAX: 330.264.2944 or  
800.531.7335 | akronbrass.com

REVISED: 7/11

WARRANTY AND DISCLAIMER: We warrant Akron Brass products for a period of five (5) years after purchase against defects in materials or workmanship. Akron Brass will repair or replace product which fails to satisfy this warranty. Repair or replacement shall be at the discretion of Akron Brass. Products must be promptly returned to Akron Brass for warranty service.

We will not be responsible for wear and tear, any improper installation, use, maintenance or storage, negligence of the owner or user, repair or modification after delivery, damage, failure to follow our instructions or recommendations or anything else beyond our control. WE MAKE NO WARRANTIES, EXPRESS OR IMPLIED OTHER THAN THOSE INCLUDED IN THIS WARRANTY STATEMENT, AND WE DISCLAIM ANY IMPLIED WARRANTY OF MERCHANTABILITY OR FITNESS FOR ANY PARTICULAR PURPOSE. Further, we will not be responsible for any consequential, incidental or indirect damages (including, but not limited to, any loss of profits) from any cause whatsoever. No person has authority to change this warranty.

© Akron Brass Company, 2011. All rights reserved. No portion of this can be reproduced without the express written consent of Akron Brass Company.

USE THESE ILLUSTRATIONS TO IDENTIFY THE VARIOUS PARTS IN THIS KIT

Item No. 1  
PN-7-72-024  
Turbine Teeth

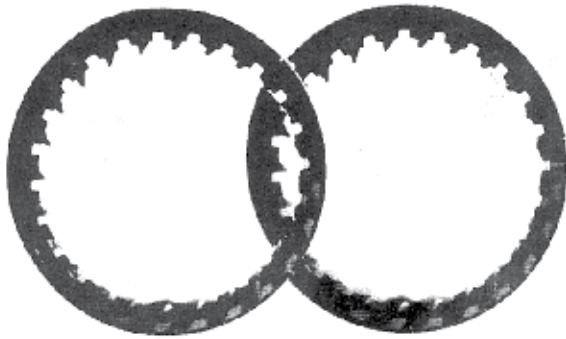

Item No. 4  
PN 7-69-245  
Seat (2)



Rivet  
PN 7-54-003  
Use to drive out Roll Pins  
in Handle Trunnions



Item No. 5  
PN 7-04-006  
Shutoff Ball

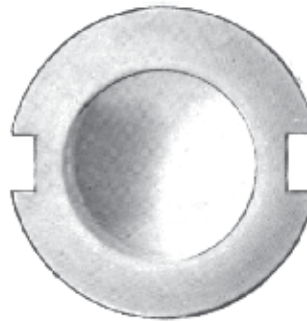

Item No. 8  
PN 7-44-080  
Roll Pin (2)



Item No. 6  
PN 7-57-032  
O-Ring  
Inlet Adapter

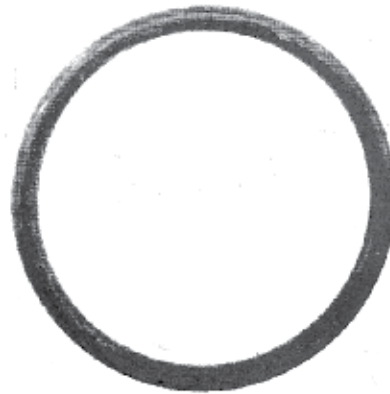

Item No. 2  
PN 7-57-034  
O-Ring (2)  
Handle Trunnion



Item No. 7  
PN 7-17-047  
Swivel Gasket

Item No. 3  
PN 7-57-050  
O-Ring (2)  
Rubber Seat

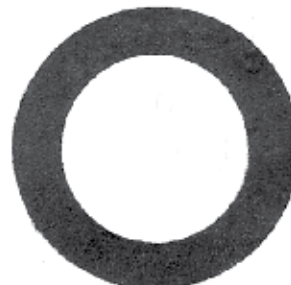
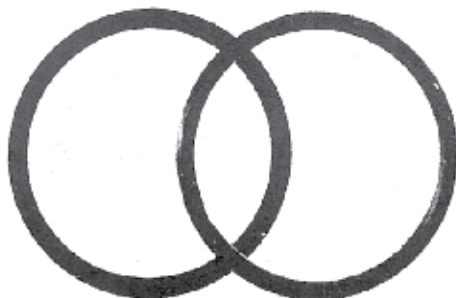

## STYLE 9115 FIELD SERVICE KIT

- FOR:**
- |              |   |             |                              |
|--------------|---|-------------|------------------------------|
| <b>1701P</b> | 1" Turbojet® (Pyrolite®)                | <b>4612</b> | 1" Marauder                  |
| <b>1702P</b> | 1" Turbojet with Pistol Grip (Pyrolite) | <b>4613</b> | 1" Marauder with Pistol Grip |
| <b>1701</b>  | 1" Turbojet (Chrome)                    |             |                              |
| <b>1702</b>  | 1" Turbojet with Pistol Grip (Chrome)   |             |                              |

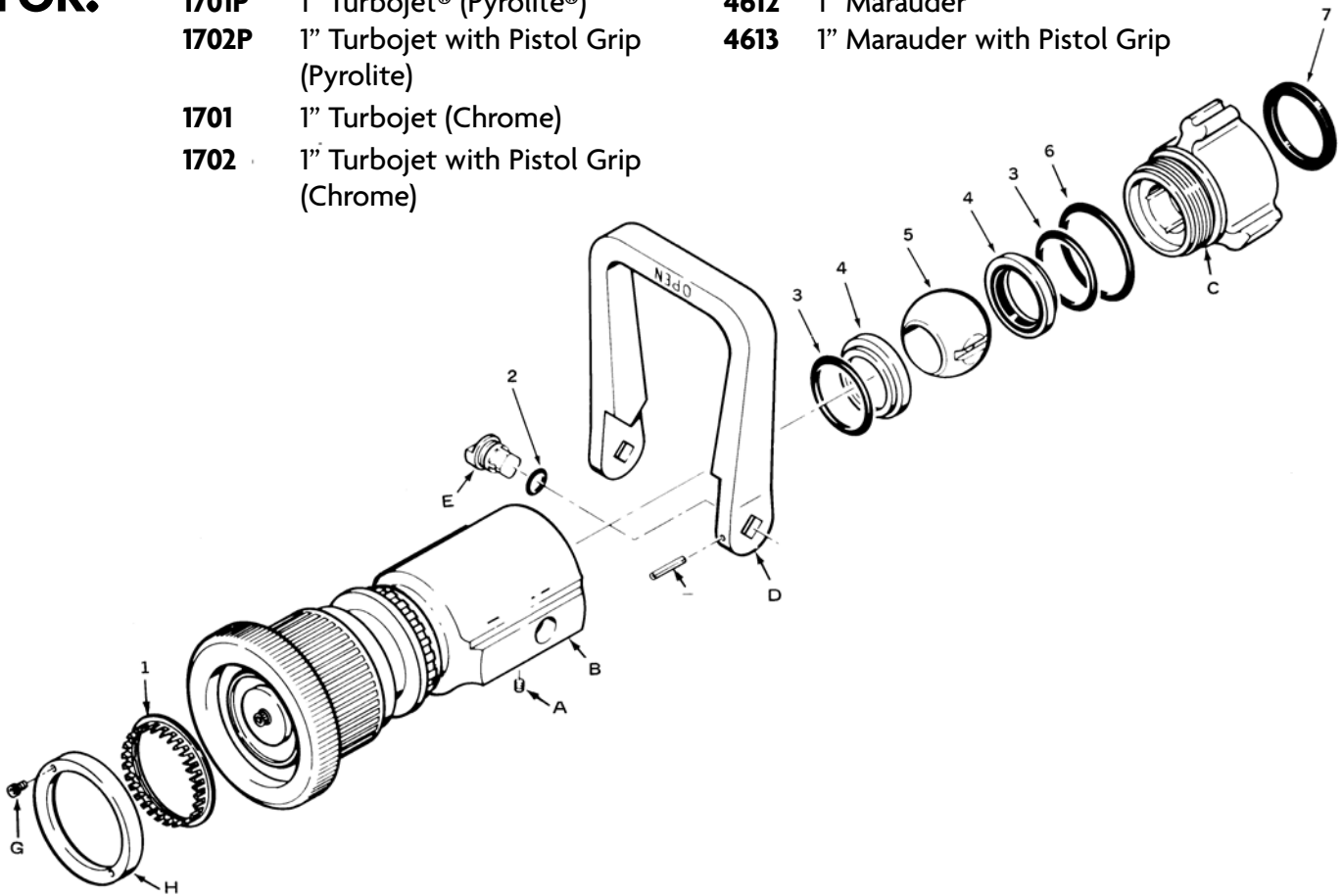

ITEM NO.	DESCRIPTION	PART NO.
1	Turbine Teeth	7-72-024
2	O-Ring (2)	7-57-034
3	O-Ring (2)	7-57-050
4	Seat (2)	7-69-245
5	Ball	7-04-006
6	O-Ring	7-57-032
7	Gasket	7-17-047
8	Roll Pins (2)	7-44-080

Parts included in this kit are normally all that are required to repair leaks in the shutoff area. If additional nozzle components are required, contact Akron Brass for the appropriate technical service bulletin or return the nozzle to our factory: Akron Brass Co., Old Mansfield Rd., Wooster, Ohio 44691 or Akron Manufacturing Co., P. O. Box 280, Aylmer, Ontario N5H2R9.

# FIELD SERVICE KIT INSTRUCTIONS

## DISASSEMBLY

1. Remove the swivel gasket (7).
2. Remove the set screw (A) at the swivel end of the shutoff body (B), with a  $\frac{1}{8}$ " Allen wrench.
3. Insert a tool  $\frac{7}{16}$ " square (for a 1" swivel adapter) into the grooves in the swivel adapter (C) and remove counterclockwise.
4. Remove the O-Ring (6) from the inlet adapter (C).
5. Remove the seat and O-Ring (4 and 3) from the inlet adapter (C).

NOTE: Any plastic spacer rings(s) must remain in the inlet adapter recess under the seat and O-Ring for proper reassembly.

6. Turn the handle (D) into the open position and remove the ball (5).

7. Mark the end of the trunnions (E) and handle so they can be reassembled in exactly the same position. (Use chalk, grease pencil, etc.)

8. Take the rivet supplied in the service parts kit and drive out the roll pins (8) securing the handle to the trunnions.

9. Push the trunnions into the shutoff body until they are free. Remove the handle and trunnions.

10. Remove the O-Rings (2) from the trunnions.

11. Remove the front seat and O-ring (4 and 3).

12. Remove the two set screws (G) on the turbine retaining ring (H) with a  $\frac{3}{32}$ " Allen wrench.

13. Remove the turbine retaining ring.

14. Remove the turbine teeth (I).

## ASSEMBLY

NOTE: All O-Rings must be lubricated with O-Ring grease before assembly.

1. Install the new O-Ring (3) on the new seats(4).
2. Insert one new seat with O-Ring into the shutoff body (B).
3. Install the new O-Rings (2) on the trunnions (E).
4. Place the handle (D) over the trunnions holes with the "closed" lettering facing the inlet.
5. Install the trunnions from inside the shutoff body, using the marks (Disassembly Step 7) to position properly.
6. Install the roll pins (8) to secure the handle to the trunnions.
7. Turn the handle into the open position and insert the new ball (5).
8. Install the other new seat with O-Ring into the recess of the inlet adapter (C).

NOTE: To be placed above the plastic spacer ring(s) if so equipped.

9. Install the new O-Ring (6) in the shutoff body recess.
10. With the handle in the closed position: Thread the

swivel adapter into the shutoff body.

NOTE: Continue tightening until resistance is felt when opening and closing the shutoff.)

11. Install the new swivel gasket (7).
12. Install the new turbine teeth (I).
13. Line up the screw holes with the holes in nozzle body and place the turbine retaining ring (H) back into position.
14. Install and tighten the set screws (G) which secure the retaining ring. Use Loctite 222 or Permabond LM113
15. Test the nozzle with water to determine if the shutoff functions properly. If a small leak is present, tighten the inlet adapter slightly to eliminate leak.
16. Once the shutoff functions properly, observe the inlet adapter through the set screw hole in the shutoff body. If a full thread is visible, drill a slight recess for the set screw (A) (use a  $\frac{3}{16}$ " drill bit.) Install and tighten the set screw. Use Loctite 222 or Permabond LN113.