

3462 Multi-Purpose Forestry Monitor Order Form

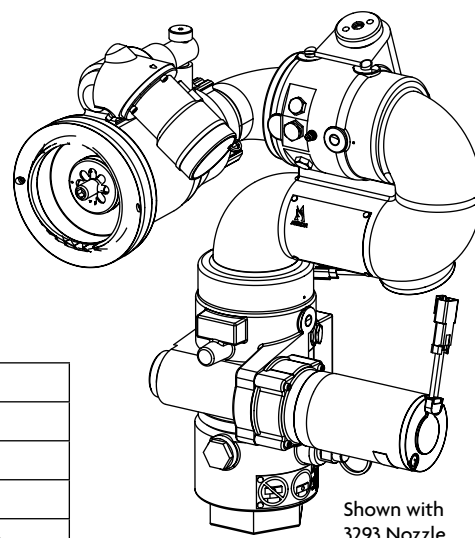

A.) Please choose one monitor configuration from the list below. This will include the monitor, joystick, 5' power/valve harness, and 20' joystick harness:

3462 <u> </u> xxx A		1 – 12V monitor
		2 – 24 V monitor
		3 – 12V monitor with 2.4Ghz wireless control option
		4 – 24V monitor with 2.4Ghz wireless control option
		5 – 12V monitor with 900Mhz wireless control option
		6 – 24V monitor with 900Mhz wireless control option



Shown with 3293 Nozzle

B.) Nozzle: Please choose one nozzle option from the list below:

3462x <u> </u> xx B		0 – No Nozzle
		1 - Adjustable (30, 60, 95, 125gpm) with Electric Flush
		2 - Adjustable (125, 175, 250, 300gpm) No Flush Feature
		4 - Adjustable (30, 60, 95, 125gpm) with Electric, Flush Flat Disperse Pattern
		5 - Adjustable (125, 175, 250, 300gpm) No Flush Feature, Flat Disperse Pattern
		6 - Adjustable (40,70,100gpm) with Electric Flush Feature, Flat Disperse Pattern

C.) Paint: Please choose one paint option from the list below:

3462xx <u> </u> x C		0 – Standard Akron Brass Red
		1 – Black (additional charge)
		2 – Lime Yellow (additional charge)
		3 – White (additional charge)
		4 – No Paint

D.) Options: Please check all options required from the list below:

3462xxx <u> </u> D		0 – No Options
		1 - 2" Electric Valve with 10' harness
		2 - Quick Disconnect Inlet
		3 – Electric valve + Quick Disconnect
		4 – Foam Tube
		5 – Electric Valve + Foam Tube
		6 – Quick Disconnect + Foam Tube
		7 – Electric Valve + Quick Disconnect + Foam Tube

3462 Final Part Number Configuration
A B C D

NOTE: For special configuration requirements, please contact Akron Brass Customer Service.
Send PO & completed order guide to akroncare@idexcorp.com or call 800.228.1161