

- NOTES:
- USE PARKER O-LUBE ON ALL O-RINGS AND MATING SURFACES UNLESS OTHERWISE NOTED.
- 1 CUT O-RING AT ASSEMBLY.
 - 2 USE PRIMER T AND PERMABOND HH120 OR LOCTITE 277.
 - 3 USE PERMABOND LM113 OR LOCTITE 222.
 - 4 TURBINE TEETH TO BE CUT AT ASSEMBLY WITH 1/16" SAW BLADE.
 - 5 DOG POINT OF SET SCREW TO BE POSITIONED INTO GROOVE OF PATTERN SLEEVE WHEN INSTALLED.
 - 6 DIMPLE AT ASSEMBLY.
 - 7 APPLY PERMABOND LM113 OR LOCTITE 222 AFTER CALIBRATION.

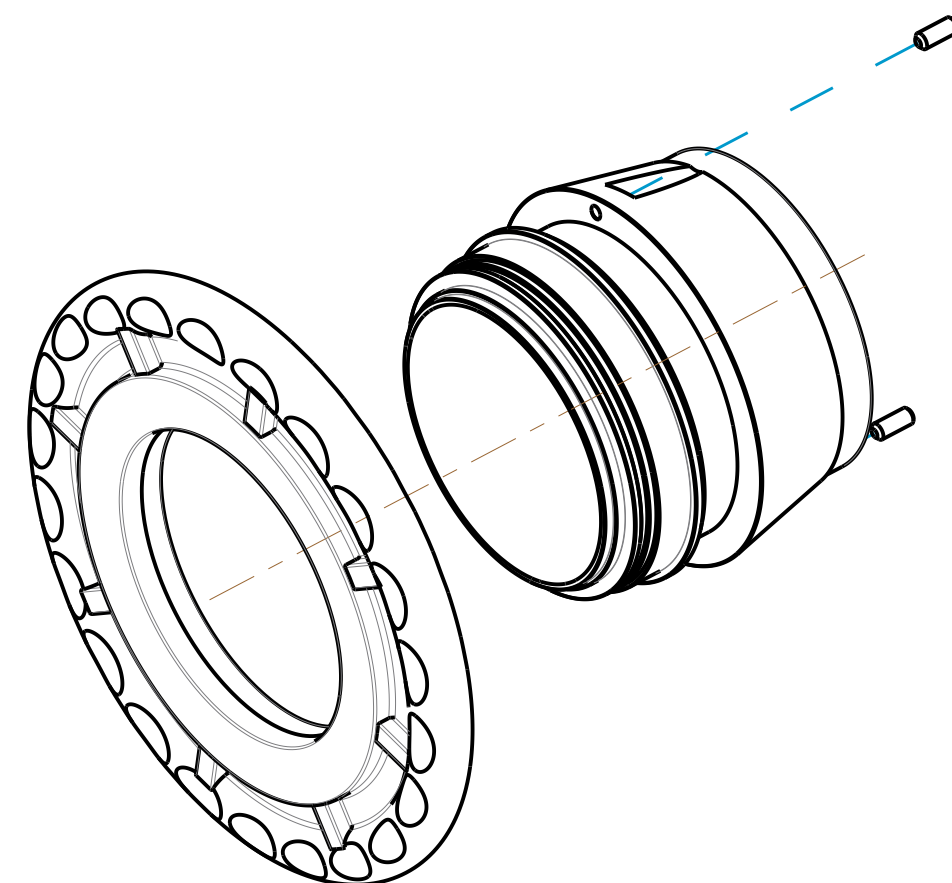

THE ABOVE PATTERN SLEEVE AND CONTROL RING HAVE BEEN DISCONTINUED. IF EITHER OF THESE ARE IN NEED OF BEING REPLACED YOU MUST ORDER THE CURRENT PATTERN SLEEVE AND HANDLES SHOWN BELOW.

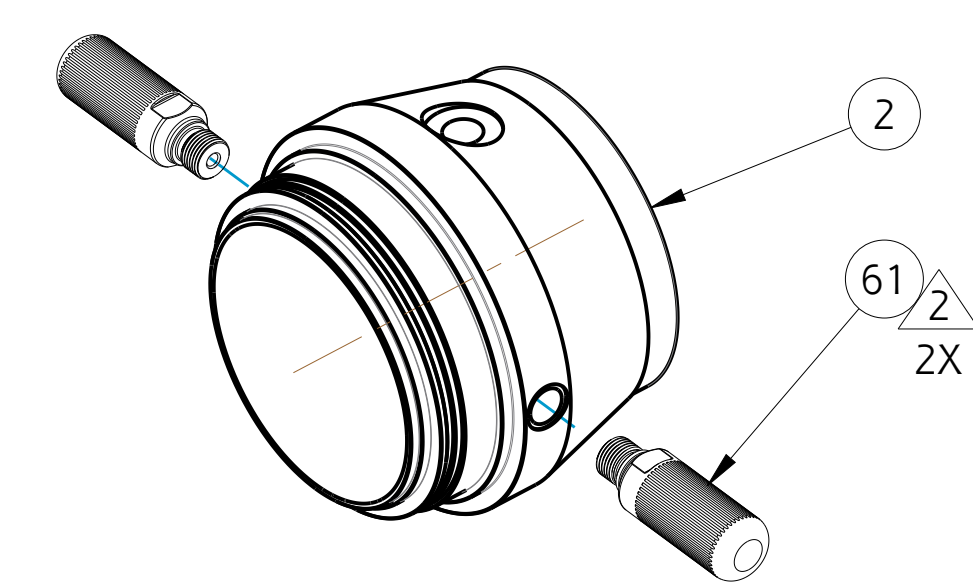

| FIND | | DESCRIPTION | ITEM | QTY. |
|------|---|------------------------------|--------|------|
| 1 | | TURBINE RETAINING RING | 102331 | 1 |
| 2 | | PATTERN SLEEVE | 124393 | 1 |
| 3 | | DISCHARGE TUBE | 102335 | 1 |
| 4 | | SCREW 3/8-16 X 1 | 767139 | 1 |
| 5 | | BAFFLE HEAD | 102326 | 1 |
| 6 | | BAFFLE STEM | 117463 | 1 |
| 8 | | TURBINE TEETH | 773062 | 1 |
| 9 | | SCREW FULL DOG 10-24 X 5/16 | 767088 | 3 |
| 10 | | O-RING 2-242 | 757251 | 2 |
| 13 | | CAM NUT | 735045 | 1 |
| 14 | | O-RING 2-233 | 757249 | 2 |
| 15 | | O-RING 2-244 | 757252 | 1 |
| 16 | | NOZZLE BODY | 117464 | 1 |
| 17 | | DETENT HANDLE | 102328 | 1 |
| 18 | | SPRING | 768026 | 1 |
| 19 | A | BALL BEARINGS | - | 39 |
| 20 | | SET SCREW 1/4-20 X 1/4 | 765002 | 1 |
| 21 | | SWIVEL ADAPTER | 102324 | 1 |
| 22 | | GASKET | 717043 | 1 |
| 23 | * | SWIVEL 2-1/2 NH | 101420 | 1 |
| 24 | A | SWIVEL PLUG | 742023 | 1 |
| 25 | | O-RING 2-235 | 757046 | 1 |
| 26 | | ID BAND 1755 | 703352 | 1 |
| 28 | | GALLONAGE BAND GPM | 703353 | 1 |
| 28 | | GALLONAGE BAND LPM | 703354 | 1 |
| 29 | | CAM HANDLE | 102329 | 1 |
| 30 | | GALLONAGE CONTROL RING | 102330 | 1 |
| 31 | | CAM ROLLER | 758160 | 1 |
| 32 | | INDICATOR PATTERN BAND - GPM | 703469 | 1 |
| 32 | | INDICATOR PATTERN BAND - LPM | 703470 | 1 |
| 33 | | KEY | 727027 | 1 |
| 34 | | SHIM BLUE | 768218 | 1 |
| 34 | | SHIM BROWN | 768219 | 1 |
| 34 | | SHIM PINK | 768220 | 1 |
| 38 | | DETENT SPRING | 769111 | 1 |
| 39 | | BALL ST STL 3/16 | 704018 | 1 |
| 41 | | O-RING 2-250 | 757102 | 1 |
| 61 | | HANDLE | 124394 | 2 |
| | | | | |
| A | | KIT OF 50 BALLS, 1/4" BRASS | 109041 | |

* FOR OTHER THREADS ORDER BY DESCRIPTION AND THREAD SIZE (ODM AND TPI) OR BY AKRON THREAD CODE.

OPERATING & MAINTENANCE INSTRUCTIONS:

THE FOUR FLOW SETTINGS ARE BASED ON 100 PSI INLET PRESSURE. MAXIMUM OPERATING PRESSURE OF 150 PSI. CHECK THE TURBINE TEETH TO BE SURE THEY TURN FREELY BEFORE OPERATING.

THE TURBINE TEETH ARE SPLIT TO ALLOW FOR EXPANSION AND CONTRACTION.

THE TURBINE TEETH ARE EASILY REMOVED FOR CLEANING OR REPLACEMENT. SIMPLY REMOVE THE THREE SET SCREWS (9), REMOVE THE TURBINE RETAINING RING (1), AND REMOVE THE TURBINE TEETH (8). TO CLEAN, SIMPLY WIPE OFF ANY DIRT AND GREASE FROM THE TURBINE TEETH AND CONTACT SURFACES ON THE TURBINE RETAINING RING AND PATTERN SLEEVE (2). IF OTHER PARTS ON THE NOZZLE ARE DISASSEMBLED, BE SURE TO THAT ANY O-RINGS ARE LUBRICATED WITH LOW-TEMP LUBRIPLATE OR EQUIVALENT BEFORE REASSEMBLY.