



TECHNICAL SERVICE PARTS

STYLE 3431

PRODUCT SINGLE INLET BASE

IF AN ITEM IS NOTED AS "NOT FIELD REPAIRABLE", OR YOU WISH TO RETURN AN ITEM TO AKRON BRASS FOR SERVICE PLEASE GO ONLINE TO, **ONLINEREPAIR.AKRONBRASS.COM**

Chg.	Date
17	05-17
18	03-19

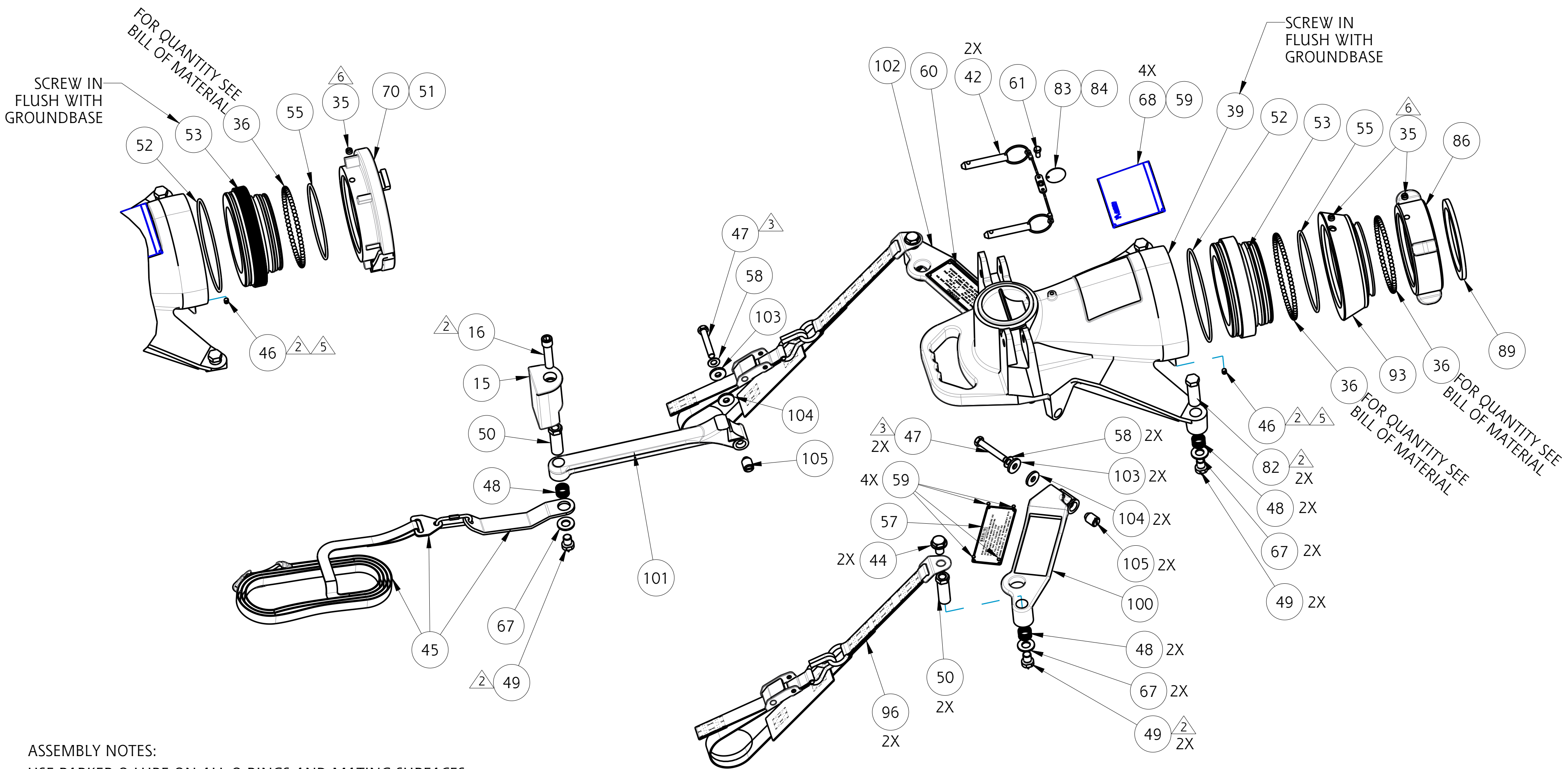

ASSEMBLY NOTES:

USE PARKER O-LUBE ON ALL O-RINGS AND MATING SURFACES
UNLESS OTHERWISE NOTED.

- 2 USE PERMABOND LM113 OR LOCTITE 222.
- 3 USE PRIMER T AND PERMABOND HH120 OR LOCTITE 277.
- 4 USE LOW-TEMP LUBRIPLATE.
- 5 DIMPLE AT ASSEMBLY.
- 6 THOROUGHLY CLEAN THREADS OF PLUG AND MATING PART AND APPLY LOCTITE 425.

PHONE: 330.264.5678 or 800.228.1161 | FAX: 330.264.2944 or 800.531.7335 | www.akronbrass.com

WARRANTY AND DISCLAIMER*: We warrant Akron Brass products for a period of five (5) years* after purchase against defects in materials or workmanship. Akron Brass will repair or replace product which fails to satisfy this warranty. Repair or replacement shall be at the discretion of Akron Brass. Products must be promptly returned to Akron Brass for warranty service. We will not be responsible for: wear and tear; any improper installation, use, maintenance or storage; negligence of the owner or user; repair or modification after delivery; failure to follow our instructions or recommendations; or anything else beyond our control. **WE MAKE NO WARRANTIES, EXPRESS OR IMPLIED, OTHER THAN THOSE INCLUDED IN THIS WARRANTY STATEMENT, AND WE DISCLAIM ANY IMPLIED WARRANTY OF MERCHANTABILITY OR FITNESS FOR ANY PARTICULAR PURPOSE.** Further, we will not be responsible for any consequential, incidental or indirect damages (including, but not limited to, any loss of profits) from any cause whatsoever. No person has authority to change this warranty. *Unless otherwise provided herein. Akron Brass industrial electronic components & the Severe-Duty Monitor have a one (1) year warranty. Select Akron Brass headline nozzles and valves carry a ten (10) year warranty. Scene Star Lights carry a (6) year warranty. Weldon products have a two (2) year warranty from date of manufacture (excluding consumable components). Select Weldon LED products carry a five (5) year warranty. Honda products have the manufacturers' warranty and Akron Brass disclaims any warranty in respect of those products.

Parts List Sheet:

124705

D40321



TECHNICAL SERVICE PARTS

STYLE 3431

PRODUCT SINGLE INLET BASE

IF AN ITEM IS NOTED AS "NOT FIELD REPAIRABLE", OR YOU WISH TO RETURN AN ITEM TO AKRON BRASS FOR SERVICE PLEASE GO ONLINE TO, **ONLINEREPAIR.AKRONBRASS.COM**

Chg.

Date

17

05-17

18

03-19

Find		Description	Item	QTY
15		STOP HOSE	104351	1
16		SCREW SOC HD CAP 1/2 -13 X 2"	767117	1
39		INLET BASE	115787	1
42		LANYARD & PINS	109023	2
44		SCREW HXHDCP 1/2 -13 X 3/4	761065	2
45		ANCHOR PLATE & STRAP	34310063	1
46		SCREW SOC HD CONE PT 1/4-20 X 3/8	765108	1
47		SCREW HEX HD 3/8 - 16 X 2 1/4"	761073	3
48	B	SPRING	-	5
49	B	GROUND SPIKE	-	5
50		SLEEVE	769303	3
52		O-RING 2-256	757250	1
57		WARNING PLATE	744309	1
58		WASHER BELLVILE	784071	3
59		NAIL GRIP	736052	12
60		TAG PRESSURE PSI TIP	773170	1
61		SCREW HX HD CAP 1/4 - 20 X 1/2	761066	1
67	B	WASHER FLAT	-	5
68		PLATE SETUP INSTRUCTIONS	744565	1
82		SLEEVE GROUNDSPIKE	769302	2
83		TAG LOCK PIN WARNING	773135	1
84		SPLIT RING	758142	1
96		STRAP ASSEMBLY STYLE 3410	769344	2
100		LEG LEFT	107718	1
101		LEG CENTER	107008	1
102		LEG RIGHT	107001	1
103		WASHER FLAT 1 X 3/8 X 1/8	784100	3
104		WASHER FLAT DELRIN 1 X 3/8 X 1/8	784099	3
105		TENSION NUT	735048	3
A		KIT OF 50 BALLS, 1/4" STAINLESS STEEL	123074	
B		GROUND SPIKE REPLACEMENT KIT	91900001	

4" NH SWIVEL				
Find		Description	Item	QTY
35	A	SWIVEL PLUG	742023	1
36	A	BALL ST 1/4"	-	127
53		INLET ADAPTER SWIVEL	104341	1
55		O-RING 2-250	757102	1
86		SWIVEL 4" NH	104015	1
89		GASKET 4"	714024	1
93		ADAPTER SWIVEL 4"	104343	1

4" STORZ				
Find		Description	Item	QTY
35	A	SWIVEL PLUG	742023	1
36	A	BALL SST 1/4"	-	55
51		4" STORZ ADAPTER	713205	1
53		ADAPTER INLET 4" STORZ	116510	1
55		O-RING 2-243	757337	1

5" STORZ				
Find		Description	Item	QTY
35	A	SWIVEL PLUG	742023	1
36	A	BALL SST 1/4"	-	62
53		ADAPTER INLET 5" STORZ	116509	1
55		O-RING 2-247	757078	1
70		5" STORZ ADAPTER	713206	1

3.50"NH SWIVEL				
Find		Description	Item	QTY
35	A	SWIVEL PLUG	742023	1
36	A	BALL SST 1/4"	-	126
53		INLET ADAPTER SWIVEL	104341	1
55		O-RING 2-250	757102	1
86		SWIVEL 3.50"NH	104014	1
89		GASKET 3.50"	714023	1
93		ADAPTER SWIVEL 3.50"	118356	1

4.50"NH SWIVEL				
Find		Description	Item	QTY
35	A	SWIVEL PLUG	742023	1
36	A	BALL SST 1/4"	-	137
53		INLET ADAPTER SWIVEL	104341	1
55		O-RING 2-250	757102	1
86		SWIVEL 4.50"NH	104016	1
89		GASKET 4.50"	714025	1
93		ADAPTER SWIVEL 4.50"	104344	1

5.00"NH SWIVEL				
Find		Description	Item	QTY
35	A	SWIVEL PLUG	742023	1
36	A	BALL SST 1/4"	-	138
53		INLET ADAPTER SWIVEL	104341	1
55		O-RING 2-250	757102	1
86		SWIVEL 5.00"NH	104017	1
89		GASKET 5.00"	714026	1
93		ADAPTER SWIVEL 5.00"	104345	1