

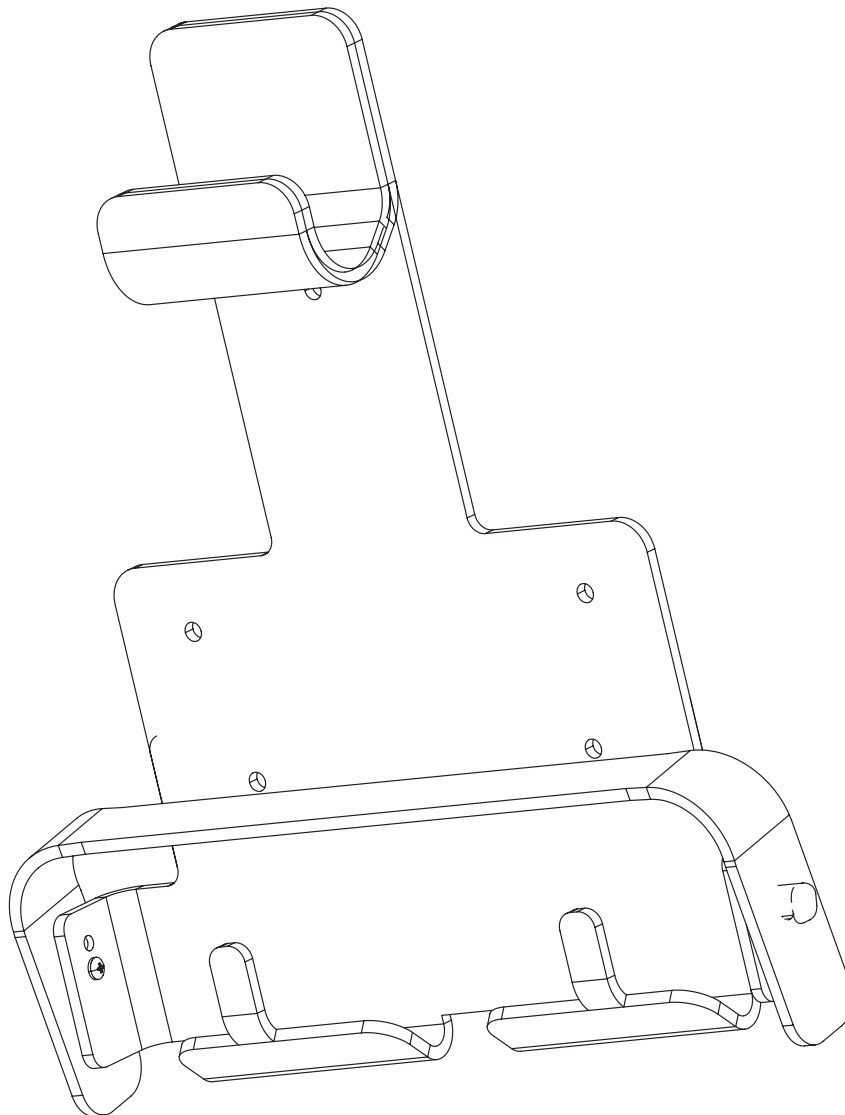

REVEL SCOUT™ MOUNTING BRACKET INSTALLATION AND OPERATING INSTRUCTIONS

The following is intended to provide the basic instructions for installation, operation, and maintenance. Read and understand these operating instructions before use.



Product Warnings

- ⚠ DANGER** • Indicates a hazardous situation which, if not avoided, WILL result in death or serious injury.
- ⚠ WARNING** • Indicates a hazardous situation which, if not avoided, COULD result in death or serious injury.
- ⚠ CAUTION** • Indicates a potentially hazardous situation which, if not avoided, may result in minor or moderate injury.
- NOTICE** • Addresses practices not related to personal injury.

⚠ WARNING Read and follow the operating instructions before use.

⚠ WARNING Mounting fixture must be secured with high quality steel or stainless steel ¼ inch diameter bolts before use.

⚠ WARNING Revel Scout™ must be secured in the mounting bracket with the supplied rubber strap.

NOTICE The Revel Scout™ mounting bracket meets NFPA 1901 equipment mounting requirements for driving or crew area when mounted in accordance with the Revel™ Scout operating instructions.

Installation

1. The Revel Scout™ mounting bracket can be mounted on a vertical or horizontal surface. The views below give acceptable and unacceptable mounting orientations which allow the mounting bracket to comply with NFPA 1901 and provide a safe environment in the crew area.

VERTICAL MOUNT

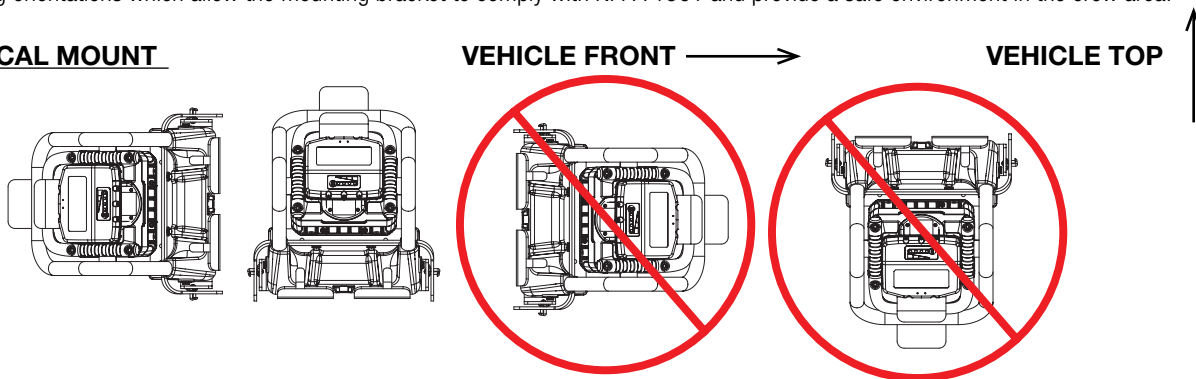

HORIZONTAL MOUNT

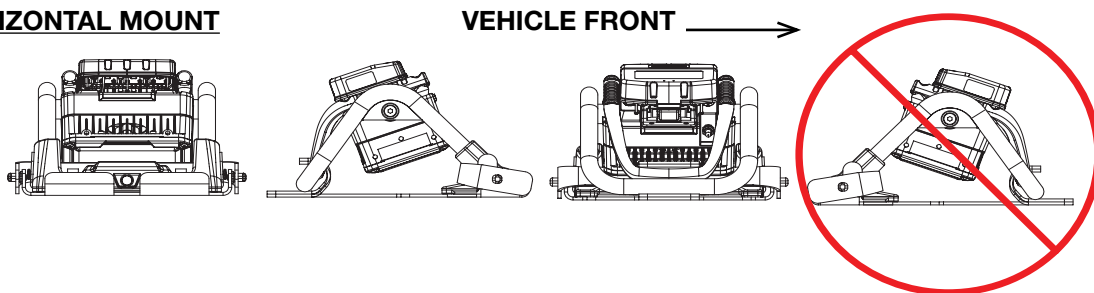

INVERTED MOUNT-NO ORIENTATIONS PERMISSABLE

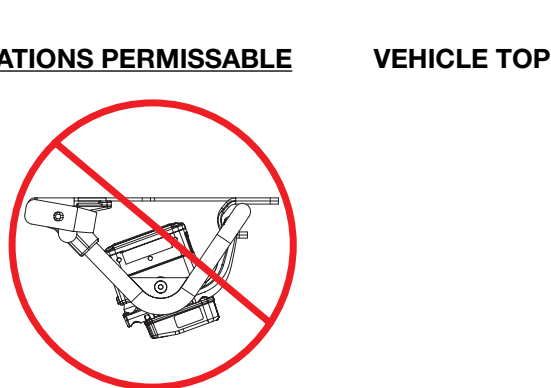

2. Position the Revel Scout™ mounting bracket in the desired location to be sure it will fit without interference.
3. Once positioned use the bracket as a template to mark the four mounting holes on the underlying surface.
4. Remove the mounting bracket and drill the required holes for ¼" fasteners.
5. Position the mounting bracket over the drilled holes and fasten the mounting bracket in position with the appropriate fasteners.
6. Figure 1 provides overall dimensions of the mounting bracket and mounting hole locations as needed.

Figure 1:

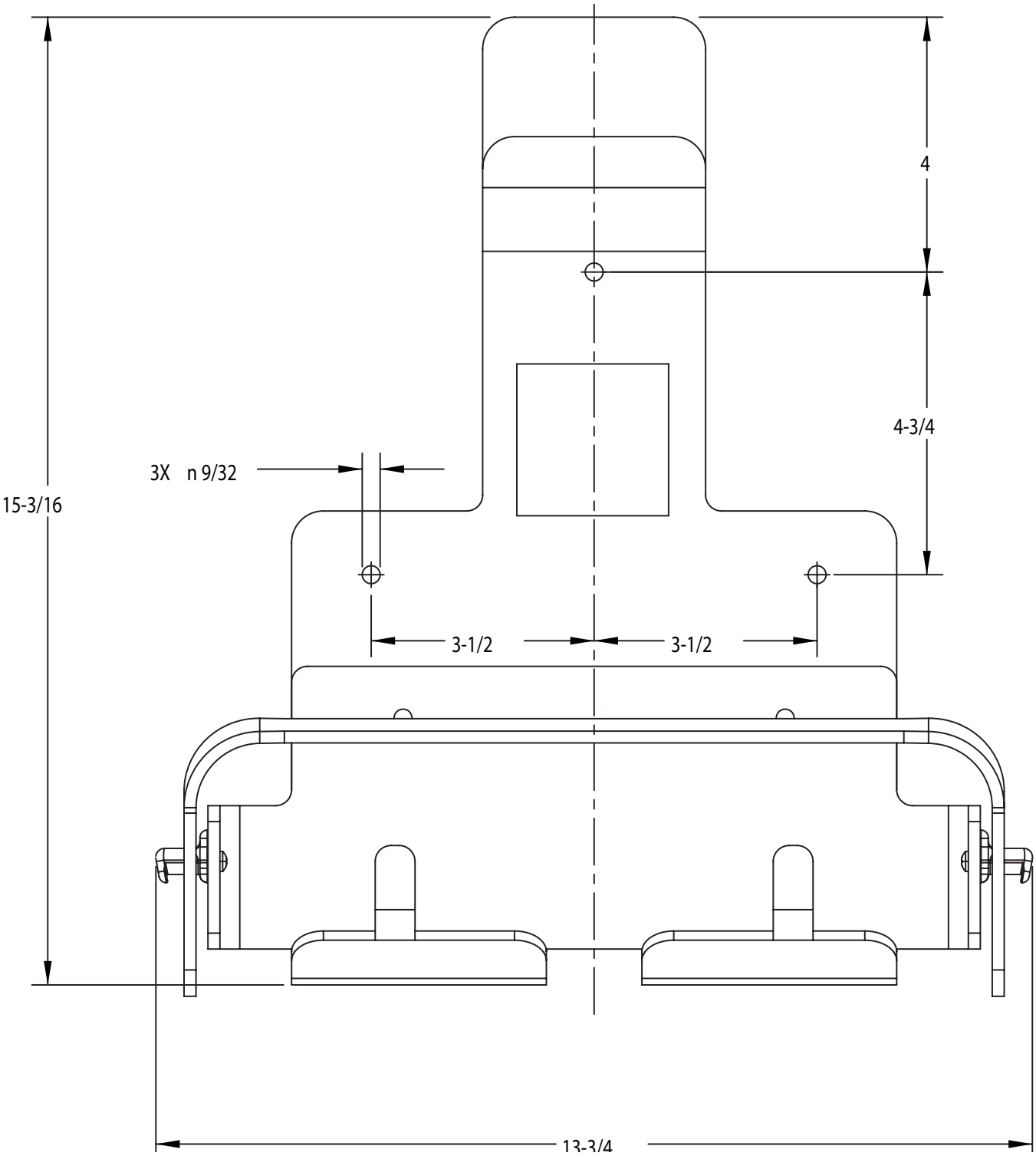

Operating Instructions

1. The Revel Scout™ light must be rotated to the full down position as shown below.
2. Remove one end of the rubber hold down strap and place the Revel Scout™ in the mounting bracket as shown below.
3. Wrap the rubber hold down strap around the foot as shown below and refasten the end of the strap to the mounting bracket.
4. The final mounting configuration is shown below.

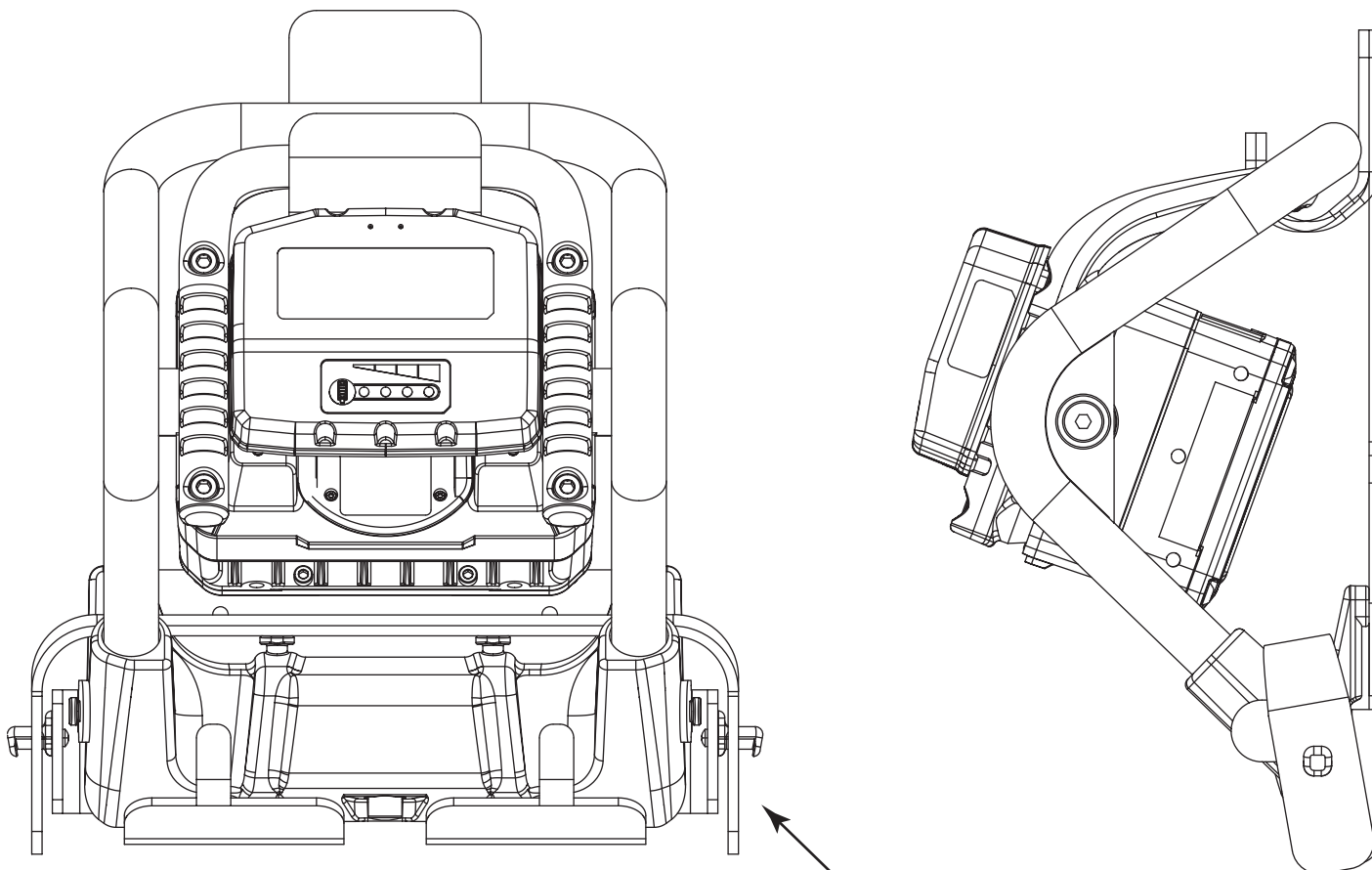

Rubber hold down strap



Tested... Proven... Trusted.

ISO 9001 REGISTERED COMPANY

PHONE: 330.264.5678 or 800.228.1161 | FAX: 330.264.2944 or 800.531.7335 | akronbrass.com

REVISED: 05/16

WARRANTY AND DISCLAIMER: We warrant Akron Brass products for a period of five (5) years after purchase against defects in materials or workmanship. Akron Brass will repair or replace product which fails to satisfy this warranty. Repair or replacement shall be at the discretion of Akron Brass. Products must be promptly returned to Akron Brass for warranty service.

We will not be responsible for: wear and tear; any improper installation, use, maintenance or storage; negligence of the owner or user; repair or modification after delivery; damage; failure to follow our instructions or recommendations; or anything else beyond our control. WE MAKE NO WARRANTIES, EXPRESS OR IMPLIED, OTHER THAN THOSE INCLUDED IN THIS WARRANTY STATEMENT, AND WE DISCLAIM ANY IMPLIED WARRANTY OF MERCHANTABILITY OR FITNESS FOR ANY PARTICULAR PURPOSE. Further, we will not be responsible for any consequential, incidental or indirect damages (including, but not limited to, any loss of profits) from any cause whatsoever. No person has authority to change this warranty.

© Akron Brass Company. 2015 All rights reserved. No portion of this can be reproduced without the express written consent of Akron Brass Company.